

## 1400 SERIES HORIZONTAL MAILBOX ASSEMBLY(FRONT LOAD)

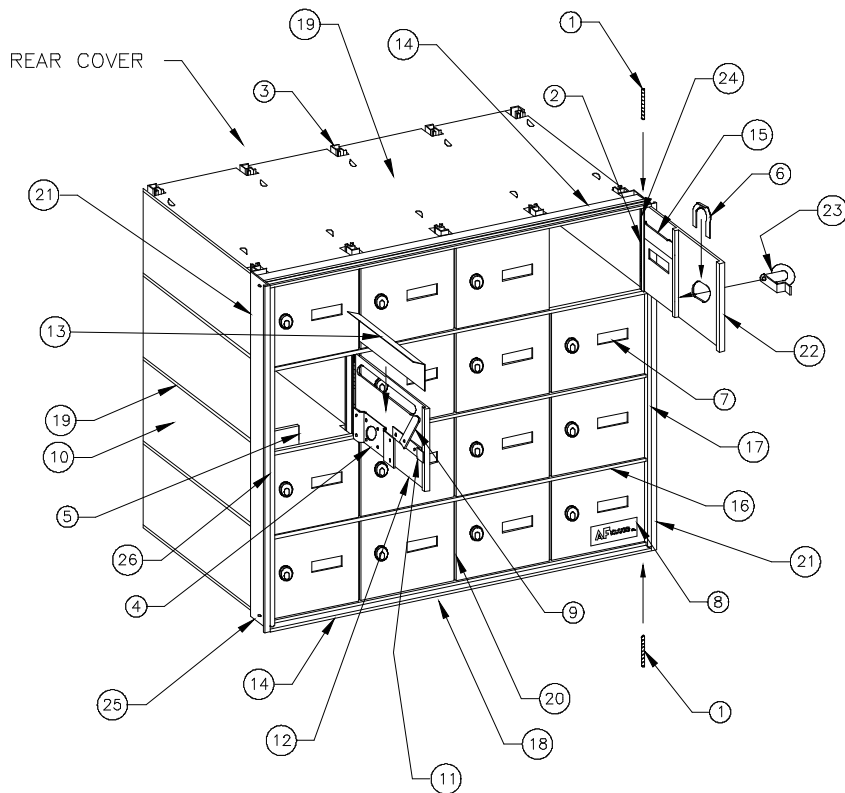

ITEM	PART DESCRIPTION	PART NUMBER
1	SPRING PIN (GATE) $\phi 3/16 \times 1''$	52600
2	SPRING (TENANT DOOR)	52918
3	CABINET - VERTICAL BAR	50122 TO 50207*
4	ARROW LOCK MOUNTING PLATE	87500
5	MASTER LOCK CATCH	51200
6	LOCK CLIP (11011-20)	30807
7	TRANSPARENT PLASTIC WINDOW	53000
8	NAME PLATE (POSTAL APPROVED)	42703
9	MAIL SLOT COVER SPACER	50002
10	PARTITION	30100S
11	MASTER DOOR LOCKING BRACKET	51400Z
12	DOOR W/P.O. LOCK & MAIL SLOT	1400POBLK00
13	MAIL SLOT COVER-MASTER DOOR	50001
14	TOP & BOTTOM FRONT TRIM	50622 TO 50677*
15	NUMBER SLOT COVER	52100
16	GATE-CROSSBAR	51001 TO 51006*
17	GATE-OUTSIDE BAR (RIGHT)	50820 TO 50893*
18	DIVIDER PLATE (BOTTOM)	55901 TO 55906*
19	DIVIDER PLATE (TOP & CENTER)	55801 TO 55806*
20	GATE-CENTER VERTICAL BAR	51120 TO 51194*
21	SIDE VERTICAL TRIM	50444 TO 50502*
22	DOOR W/STD CAM LOCK & #SLOT	1400CANSL
23	5-PIN CYLINDER CAM LOCK	30801
24	HINGE PIN (COMPARTMENT DOOR)	52960
25	APEX TORX SCREW	52298
26	GATE-OUTSIDE BAR (LEFT)	50420 TO 50493
N/I	CROSS BRACKET	52204
N/I	REAR COVER	52022 TO 52126
N/I	SD44BS POP RIVET	30397

**NOTES:**

1. 'N/I' INDICATES PART NOT ILLUSTRATED.
2. '\* ' INDICATES LAST DIGITS OF PART NUMBER CORRESPOND TO CABINET HEIGHT OR WIDTH.
3. DRAWING NOT TO SCALE.